

Whisper-Flex® Compensating Cable
with a Lifetime Warranty

US Patent 4,716,989

Part Number	Product Code	Cable Weight lbs/ft • kg/m	Chain Trade Size inches • mm	Cable Nom. OD inches • mm	Max. Hang Length feet • meters	Nom. Loop Width inches • mm
18-075-97	WF 75	0.75 • 1.1	3/16 • 5.5	1.05 • 27	600 • 183	22 • 540
18-010-97	WF 10	1.0 • 1.5	3/16 • 5.5	1.15 • 29	600 • 183	24 • 610
18-015-97	WF 15	1.5 • 2.2	1/4 • 7	1.36 • 35	600 • 183	24 • 610
18-020-97	WF 20	2.0 • 3.0	1/4 • 7	1.50 • 38	520 • 158	26 • 660
18-025-97	WF 25	2.5 • 3.7	5/16 • 8	1.63 • 41	600 • 183	26 • 660
18-030-97	WF 30	3.0 • 4.5	5/16 • 8	1.77 • 45	505 • 154	26 • 660
18-035-97	WF 35	3.5 • 5.2	3/8 • 10	1.91 • 49	600 • 183	27 • 690
18-040-97	WF 40	4.0 • 6.0	3/8 • 10	2.03 • 52	530 • 162	27 • 690



Wire Rope, Compensation & Accessories

Whisper-Flex cable provides smooth operation at temperatures of -15° C to +60° C and, in the US, can be used for elevators with rated speeds of no greater than 700 ft/min • 3.56 m/sec.*

Support brackets, U-bolts, S-hooks, and heavy duty stainless steel grips specifically designed for Whisper-Flex cable must be used to ensure safe installations. See pages 66 - 67 for details on this hardware.

Draka EP dampening devices are recommended to minimize cable sway for car speeds above 350 ft/min (1.8 m/sec). See pages 68 - 69 for information on these devices.

This diagram shows the approximate placement of components for a Whisper-Flex cable installation. Refer to the Compensating Cable Installation Guide for exact instructions on installation procedures.

Draka EP can help you determine which size of Whisper-Flex cable to use. Call 1-877-372-5237 or +1-252-984-5100 and have the following information ready:

- 1) number of hoist ropes per car
- 2) outer diameter of the hoist ropes
- 3) stranding of the hoist ropes (i.e. 8x19, 8x25...)
- 4) car roping (i.e. 1:1, 2:1, other...)
- 5) number of Whisper-Flex cables per car
- 6) length of Whisper-Flex cable needed

*based on the most current code at the time of printing; ASME A17.1 - 2007, Rule 2.21.4.2 Compensating Rope Tie-Down

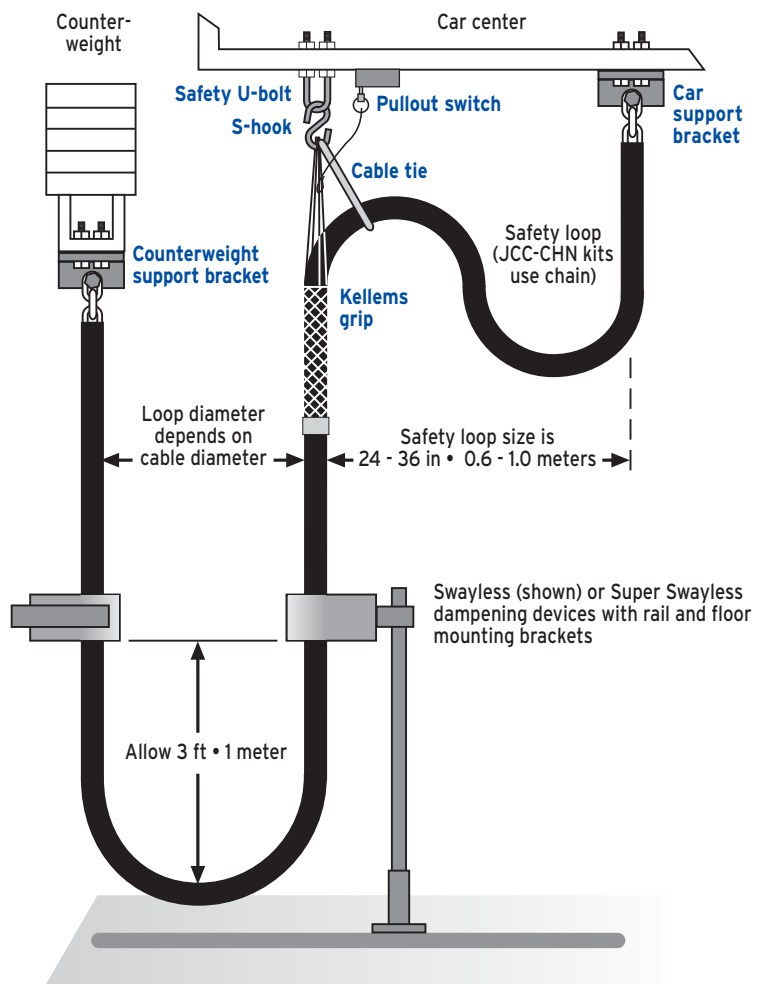

Stripping service 1 1/2 and 3 1/2 links exposed

Part Number	Description
WFSTRIP1.5L	Cable with 1-1/2 links stripped at one end
WFSTRIP3L	Cable with 3-1/2 links stripped at one end



Stedi-Flex® Compensating Cable

with a Lifetime Warranty

Patent pending

Part Number	Product Code	Cable Weight lbs/ft • kg/m	Chain Trade Size inches • mm	Cable Nom. OD inches • mm	Max. Hang Length feet • meters	Nom. Loop Width* inches • meters
18-L15-97	SFC 15	1.5 • 2.2	1/4 • 7	1.39 • 35	600 • 183	38 to 46 • 0.97 to 1.17
18-L20-97	SFC 20	2.0 • 3.0	1/4 • 7	1.56 • 40	520 • 158	38 to 47 • 0.97 to 1.20
18-L25-97	SFC 25	2.5 • 3.7	5/16 • 8	1.67 • 42	600 • 183	39 to 48 • 0.99 to 1.22
18-L30-97	SFC 30	3.0 • 4.5	5/16 • 8	1.82 • 46	505 • 154	39 to 49 • 0.99 to 1.25
18-L35-97	SFC 35	3.5 • 5.2	3/8 • 10	1.91 • 49	600 • 183	40 to 50 • 1.02 to 1.27
18-L40-97	SFC 40	4.0 • 6.0	3/8 • 10	2.04 • 52	530 • 162	40 to 50 • 1.02 to 1.27

Stedi-Flex cables are available with 4 week lead time.

*NOTE: Loop diameter varies with application (ex. car speed, distance between support points)



Stedi-Flex cable is a wide-loop version of our popular Whisper-Flex cable designed for use on elevators with greater than 400 feet • 122 m of travel or with elevators that have a side counterweight. It provides smooth operation at temperatures of -15° C to +60° C and can be used for elevators with rated speeds of no greater than 700 ft/min • 3.56 m/sec.*

Support brackets, U-bolts, S-hooks and heavy duty couplings specifically designed for Stedi-Flex cable must be used to ensure safe installations. Shallow pit installation hardware (JCC-XX-CHN) is recommended for use with Stedi-Flex. See pages 66 - 67 for details on this hardware.

Draka's EP's ShallowSwayless dampening device is recommended for use with Stedi-Flex to minimize cable sway for car speeds above 350 ft/min (1.8 m/sec). See page 70.

Refer to the JCC-XX-CHN sections of the Compensating Cable Installation Guide for exact instructions on installation procedures.

Draka EP can suggest which size of Stedi-Flex cable to use. Call 1-877-372-5237 or +1-252-984-5100 and have the following information ready:

- 1) number of hoist ropes per car
- 2) outer diameter of the hoist ropes
- 3) stranding of the hoist ropes (i.e. 8x19, 8x25...)
- 4) car roping (i.e. 1:1, 2:1, other...)
- 5) number of Stedi-Flex cables per car
- 6) length of Stedi-Flex cable needed

If replacing existing compensation, have ready the chain link size or cable brand name and outer diameter.

*based on the most current code at the time of printing: ASME A17.1 - 2007, Rule 2.21.4.2 Compensating Rope Tie-Down

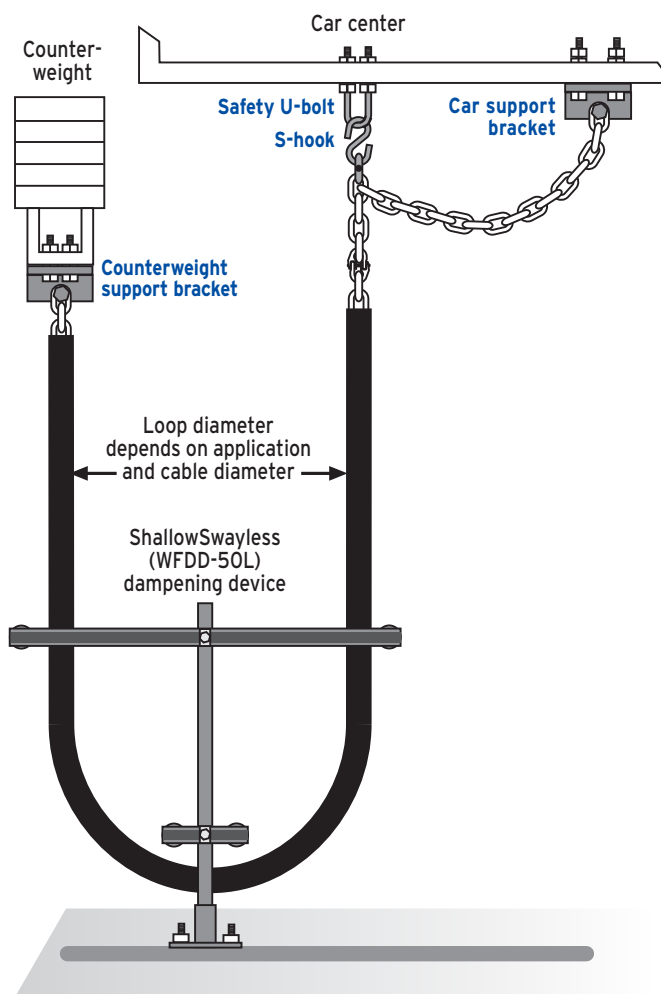

Wire Rope, Compensation & Accessories

Stripping service 1 1/2 and 3 1/2 links exposed

Part Number	Description
WFSTRIP1.5L	Cable with 1-1/2 links stripped at one end
WFSTRIP3L	Cable with 3-1/2 links stripped at one end

Compensating Cable Installation Hardware

Installation kits for Whisper-Flex and Steadi-Flex

JCC installation kits for Whisper-Flex in standard pits (imperial components)

Part Number	For Use on Cable	Support Bracket Part No.	U-bolt Size	S-hook Part No.	Grip Part No.	Electrical Tape Part No.
JCC-10	WF 75 & 10	n/a	3/8 in.	79-011	024-20-1504	16-005
JCC-15	WF 15	n/a	3/8 in.	79-013	024-20-1470	16-005
JCC-20	WF 20	n/a	3/8 in.	79-013	024-20-1510	16-005
JCC-25	WF 25	n/a	3/8 in.	79-016	024-20-1510	16-005
JCC-30	WF 30	n/a	3/8 in.	79-016	024-20-1499	16-005
JCC-35	WF 35	n/a	3/8 in.	79-016	024-20-1499	16-005
JCC-40	WF 40	n/a	3/8 in.	79-016	024-20-1542	16-005

JCC installation kits contain 2 Support Brackets (includes grade 8 nuts, bolts, lockwashers and hardened washers), 1 U-bolt (includes nuts and washers), 1 S-hook, a mesh grip and electrical tape.

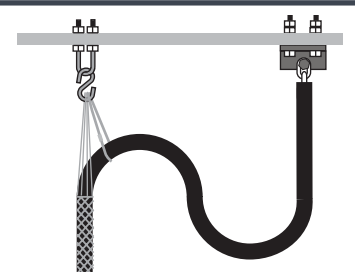

JCCML installation kits for Whisper-Flex cables (metric components)

Part Number	For Use on Cable	U-bolt Size	S-hook Part No.	Grip Part No.	Electrical Tape Part No.
JCCML-10	WF075 & 10	10 mm	79-011	024-20-1504	16-005
JCCML-15	WF15	10 mm	79-013	024-20-1470	16-005
JCCML-20	WF20	10 mm	79-013	024-20-1510	16-005
JCCML-25	WF25	12 mm	79-016	024-20-1510	16-005
JCCML-30	WF30 & 35	12 mm	79-016	024-20-1499	16-005
JCCML-40	WF40	12 mm	79-016	024-20-1542	16-005

JCCML installation kits contain 3 U-bolts (includes nuts and washers), 1 S-hook, a mesh grip and electrical tape.

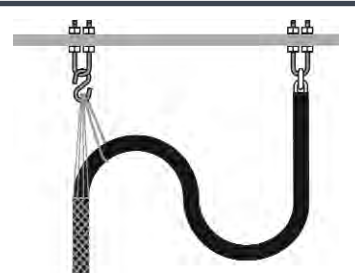

JCC-CHN installation kits for Steadi-Flex (and Whisper-Flex in shallow pits)

Part Number	For Use on Cable	Support Bracket Part No.	U-bolt Size	S-hook Part No.	Coupling Quantity and Size	Chain Size
JCC-10-CHN	WF 75 & 10	n/a	3/8 in.	79-011	(1) 9/32 in.	5/16 in.
JCC-20-CHN	WF/SFC 15 & 20	n/a	3/8 in.	79-013	(1) 9/32 in.	5/16 in.
JCC-30-CHN	WF/SFC 25 & 30	n/a	3/8 in.	79-016	(2) 9/32 in.	3/8 in.
JCC-40-CHN	WF/SFC 35 & 40	n/a	3/8 in.	79-016	(1) 9/32 in., (1) 3/8 in.	3/8 in.

JCC-CHN installation kits contain 2 Support Brackets (includes grade 8 nuts, bolts, lockwashers and hardened washers), 1 U-bolt (includes nuts and washers) and 1 S-hook. JCC-CHN kits use 1 or 2 couplings and a 4 ft. length of chain to form the safety/adjustment loop.

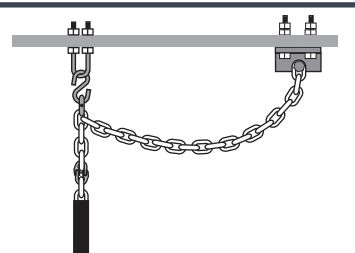

Coupling kits for shallow pits

Part Number	For Use on Compensating Cable	Chain Size	Coupling Quantity and Size
WF-20-CPLG	WF/SFC 10, 15 & 20	5/16 in.	(1) 9/32 in.
WF-30-CPLG	WF/SFC 25 & 30	3/8 in.	(2) 9/32 in.
WF-40-CPLG	WF/SFC 35 & 40	3/8 in.	(1) 9/32 in., (1) 3/8 in.

Coupling kits consist of the chain and coupling(s) from the JCC-CHN installation kits. They DO NOT include mounting brackets, U-bolts or S-hooks.



Important note on safety and warranty for Whisper-Flex and Steadi-Flex:

These components are specifically designed for the installation of Whisper-Flex/Steadi-Flex cables. ONLY THE S-HOOK, MESH GRIP AND COUPLINGS ARE AVAILABLE SEPARATELY. USE OF OTHER HARDWARE (non-Draka EP components) COULD SERIOUSLY JEOPARDIZE THE SAFETY OF THE WHISPER-FLEX OR STEADI-FLEX CABLE INSTALLATION AND WILL VOID ANY WARRANTY.

Compensating Cable Installation Hardware

Designed specifically for Whisper-Flex and Steadi-Flex

Stainless steel mesh grip - Double eye/double weave/closed mesh

Part Number	For use on Cables	Eye Length inches • mm	Nom. Mesh Length inches • mm	Maximum Load* lbs • kg
024-20-1504	WF 10	12.0 • 305	14.0 • 356	1200 • 545
024-20-1470	WF 15	12.0 • 305	15.0 • 381	1640 • 745
024-20-1510	WF 20, WF 25	12.0 • 305	17.0 • 432	1660 • 755
024-20-1499	WF 30, WF 35	12.0 • 305	19.0 • 483	1800 • 818
024-20-1542	WF 40	12.0 • 305	21.0 • 533	1800 • 818



Support bracket - two required - not available separately

Part Number	For use on Cables	Overall Size (AxBxC) inches • mm	Hole D Diameter inches • mm	Slot Size inches • mm	Slot Center to Center inches • mm
n/a	WF 10	3 x 3 x 5 • 76 x 76 x 127	3/8 • 9.5	1/2 x 7/8 • 13 x 22	2-5/8 • 66.7
n/a	WF/SFC 15 to WF/SFC 30	3 x 3 x 5 • 76 x 76 x 127	7/16 • 11	1/2 x 7/8 • 13 x 22	2-5/8 • 66.7
n/a	WF/SFC 35 to WF/SFC 40	3 x 3 x 5 • 76 x 76 x 127	1/2 • 13	1/2 x 7/8 • 13 x 22	2-5/8 • 66.7

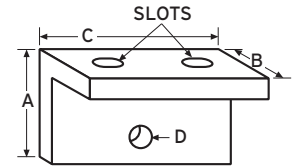

Steel U-bolt - one required - not available separately

Part Number	For use on Cables	Dim. A inches • mm	Dim. B inches • mm	Dim. C inches • mm	Dim. T inches • mm	Maximum Load* lbs • kg
n/a	WF 10 WF/SFC 15 to WF/SFC 40	3/8 • 9.5	4-3/4 • 121	2-7/8 • 73	3 • 76	2320 • 1052

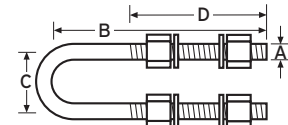

Steel S-hook - one required - available for individual replacement†

Part Number	For use on Cables	Dim. A inches • mm	Dim. B inches • mm	Dim. C inches • mm	Dim. D inches • mm	Dim. E inches • mm	Yield Strength lbs • kg
79-011	WF 10	3/8 • 9.5	2-3/8 • 60	3/4 • 19	1-1/8 • 29	17/32 • 14	1200 • 544
79-013	WF/SFC 15 to WF/SFC 20	3/8 • 9.5	2-3/4 • 70	3/4 • 19	1-1/8 • 29	1/2 • 13	2400 • 1088
79-016	WF/SFC 25 to WF/SFC 40	17/32 • 13.5	3 • 76	1 • 25	1-1/8 • 29	19/32 • 15	4800 • 2177

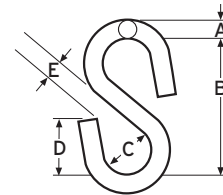

Coupling - one or two required for JCC-CHN installation - see page 66

Part Number	For use on Cables	For Chain Size inches • mm	Dim. A inches • mm	Dim. B inches • mm	Working Load Limit lbs • kg
79-116	WF 10 to 20	9/32 • 7	2-17/32 • 64	15/16 • 23	4300 • 1950
79-117	WF/SFC 25 to 40	3/8 • 10	3-7/16 • 87	2-3/8 • 60	8800 • 4000

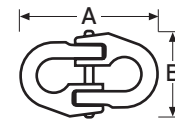

*Maximum Load is based on minimum breaking strength with a 5:1 safety factor.

†Since the S-Hook is designed to yield in order to alleviate possible damage in the event of obstruction, this item is available for replacement purposes.

Important note on safety and warranty for Whisper-Flex and Steadi-Flex:

Draka EP's compensating cable installation hardware was developed specifically for use in supporting compensating cable. When used as recommended, this support system will ensure safe compensating cable operation.

USE OF OTHER HARDWARE (non-Draka EP components) COULD SERIOUSLY JEOPARDIZE THE SAFETY OF THE WHISPER-FLEX OR STEADI-FLEX CABLE INSTALLATION AND WILL VOID ANY WARRANTY.

Compensating Cable Accessories

Swayless® dampening device for speeds up to 500 ft/min • 2.54 m/sec

US Patent 6,234,277 - two required per installation - mounting brackets sold separately

Part Number	Overall Dimensions	Center opening	Quantity
WF-SRD	6-1/4 x 3-15/16 x 2-3/4 in.	2-3/4 in.	2
WF-SRD-1	6-1/4 x 3-15/16 x 2-3/4 in.	2-3/4 in.	1
WF-SRD-M*	158 x 100 x 70 mm	70 mm	2
WF-SRD-BR	brass ring replacement	2-3/4 in. • 70 mm	1

*NOTE: Metric version uses metric nuts and bolts for closure and attachment.

WF-SRD Swayless dampening devices are recommended for maintaining smooth operation of Whisper-Flex/Steady-Flex compensating cables for speeds of up to 500 feet/min • 2.54 m/sec.

The purpose of the WF-SRD is to dampen any oscillation or cable sway that may be generated by cable motion at higher speeds. The dampening device is not usually required but can be used for speeds less than 350 feet/min • 1.78 m/sec. Proper installation requires that compensating cable should not contact the ring of the dampening device when the cable is stationary. Cable must be centered within the holes.

As the car and counterweight move, the dampening device keeps the compensating cable in position for optimum operation.

The WF-SRD can be used for Whisper-Flex sizes WF10 to WF30, Steady-Flex sizes SFC 15 to 30 and QuietLink II sizes QL075 to QL30. Draka EP offers mounting brackets for easy installation in the elevator pit. Consult the Compensating Cable Installation Guide for the installation of dampening devices.

For shallow pits not allowing three feet height above cable loop, please call Draka EP for engineering assistance.

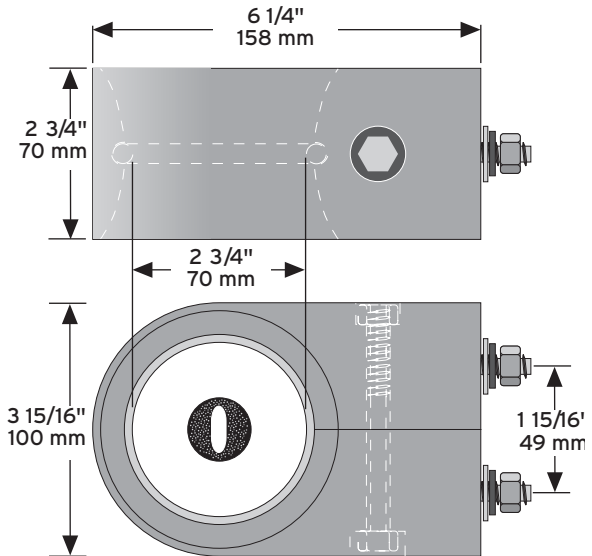

Swayless® mounting brackets

Part Number	Description
SL-FMB-48	(2) floor-mounted brackets, adjustable to 48 in. • 1.2 m height
SL-FMB-2	(2) floor-mounted brackets, adjustable to 48 in. • 1.2 m height, includes (2) Swayless devices
SL-RMB-60	Counterweight rail-mounted bracket, adjustable to 60 in. • 1.5 m width
SL-RMB-2	Counterweight rail-mounted bracket, adjustable to 60 in. • 1.5 m width, includes (2) Swayless devices

These brackets are especially designed to help you to quickly and easily install Swayless devices off the counterweight guide rails and off the pit floor. They come with all the necessary hardware, including nuts and bolts.

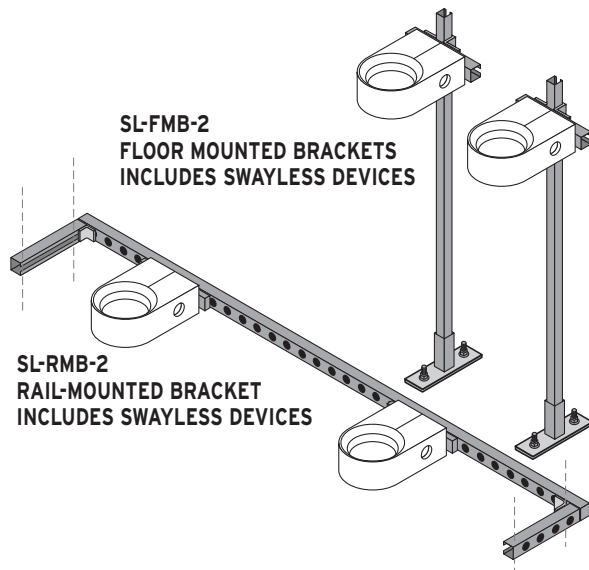

Compensating Cable Accessories

Super Swayless® dampening device for speeds up to 700 ft/min • 3.56 m/sec

Two required per installation - mounting brackets sold separately

Part Number	Overall Dimensions inches • mm	Mounting Hole Dia. inches • mm	Quantity
WF-RDD2	8 x 8 x 3.1 • 203 x 203 x 79	1/2 • 13	1

WF-RDD2 Super Swayless dampening devices have an improved design and are recommended for maintaining smooth operation of compensating cables for speeds of up to 700 feet/min • 3.56 m/sec.

The WF-RDD2 uses free-turning nylon rollers to contain and dampen any oscillation or cable sway that may be generated by cable motion at higher speeds. It can be used for all sizes of Whisper-Flex, Steadi-Flex and QuietLink II compensating cables.

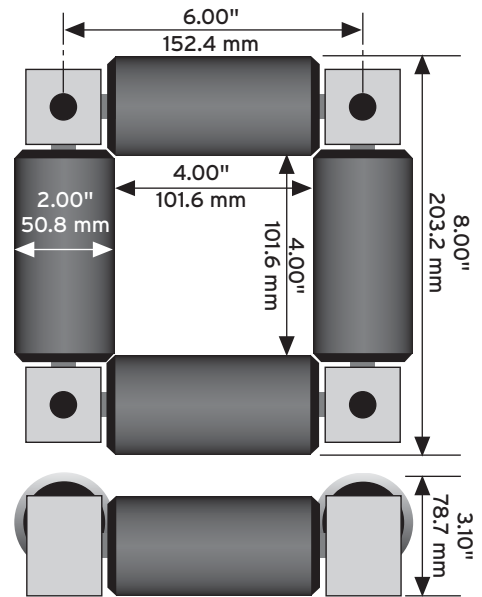

Wire Rope, Compensation
& Accessories

Super Swayless® mounting brackets

Part Number	Description
SSL-FMB-48	(2) floor-mounted brackets, adjustable to 48 in. • 1.2 m height, order WF-RDD2 separately
SSL-RMB-72	Counterweight rail-mounted bracket, adjustable to 72 in. • 1.8 m width, order WF-RDD2 separately
SSL-RMB-2	Counterweight rail-mounted bracket, adjustable to 72 in. • 1.8 m width, includes (2) Super Swayless devices

These brackets are especially designed to help you to quickly and easily install Super Swayless devices off the counterweight guide rails and off the pit floor. They come with all the necessary hardware, including nuts and bolts.

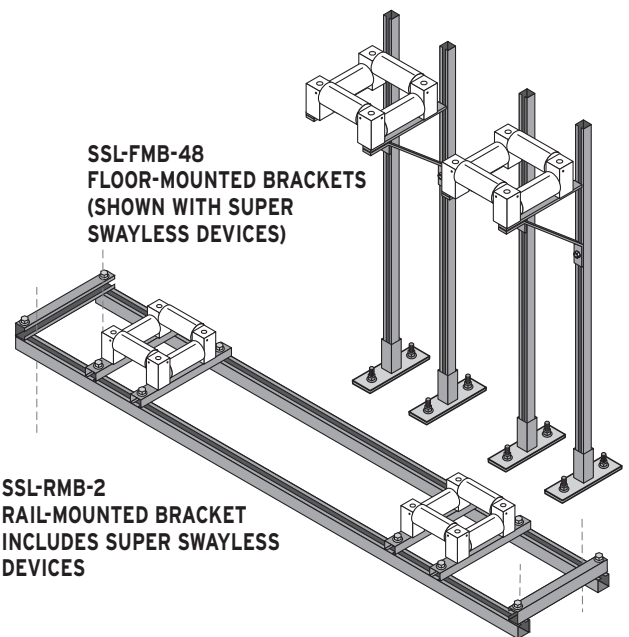

Compensating Cable Accessories

ShallowSwayless® for speeds up to 700 ft/min • 3.56 m/sec

Patent pending

Part Number	Description
WFDD-27L	ShallowSwayless kit, for Whisper-Flex cable with 23 to 27 inch loop
WFDD-50L	ShallowSwayless kit, for Steadi-Flex cable with 38 to 50 inch loop

The ShallowSwayless is a sway reduction device for shallow pit applications where there is insufficient pit depth for Swayless or SuperSwayless devices. It reduces compensating cable sway and oscillation in installations up to 700 ft/min • 3.56 m/sec. Two sizes are available; the 27L version is for Whisper-Flex and the 50L version is for Steadi-Flex.

The kit includes all components shown, including mounting bolts and washers.

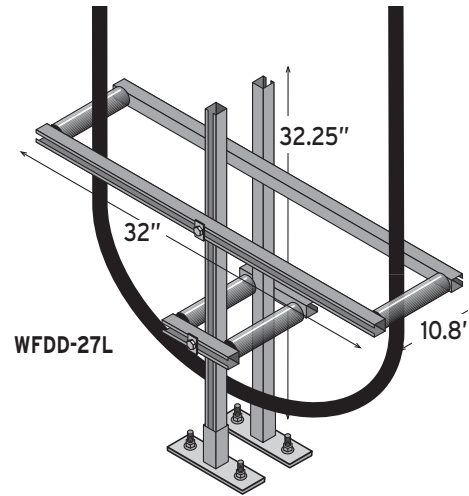

Wire Rope, Compensation & Accessories

Pullout switch and kit

Part Number	Description	Quantity
36-207	Pullout switch, with flat key actuator and rotating head	1
WF-POSK	Pullout switch installation kit, which includes one pullout switch (#36-207), two split O-rings, two cable ties, two 4 x 40 mm pan-head screws, two 4 mm hex nuts, four 4 mm flat washers and two 4 mm lock washers. An adapter is included for imperial conduit fittings.	1

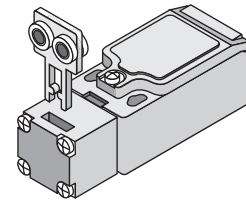

The pullout switch is UL and C-UL listed and conforms to EN1088, EN292, EN60947-5-1, EN60204-1 and EN50047. The switch enclosure meets NEMA 6.

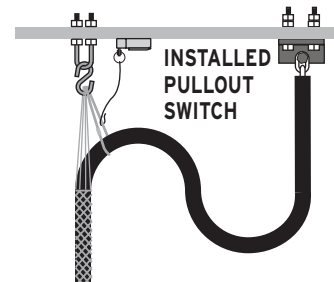

Metric Compensating Cable

QuietLink™ II cable and installation kits

Not available
in all areas

Metric sizes

Part Number	Product Code	Cable Weight	Chain Trade Size (nom. ± 0.5 mm)	Cable Nom. OD	Max. Hang Length	Nom. Loop Width
16-075-97	QL075	1.12 kg/km	6.0 mm	24 mm	160 m	610 mm
16-010-97	QL10	1.49 kg/km	6.0 mm	26 mm	160 m	610 mm
16-012-97	QL125	1.88 kg/km	7.0 mm	31 mm	160 m	610 mm
16-015-97	QL15	2.24 kg/km	7.5 mm	32 mm	130 m	610 mm
16-020-97	QL20	2.98 kg/km	8.5 mm	37 mm <td 160 m	660 mm	
16-025-97	QL25	3.73 kg/km	10 mm	42 mm	180 m	660 mm
16-030-97	QL30	4.47 kg/km	11 mm	44 mm	180 m	660 mm
16-035-97	QL35	5.22 kg/km	12 mm	48 mm	150 m	690 mm
16-040-97	QL40	5.96 kg/km	13 mm	52 mm	150 m	690 mm



QuietLink II cable provides smooth operation at temperatures of -15° C to +60° C, and can be used for elevators with rated speeds of up to 3.5 m/sec. It is similar in construction to Whisper-Flex only without the metallic beads in the filler/jacket.

Support brackets, U-bolts, S-hooks, heavy-duty stainless steel grips and/or other devices should be used to ensure safe installations. See page 73 for details on this hardware.

Draka EP dampening devices are recommended to minimize cable sway for car speeds above 1.78 m/sec. See pages 68 - 69 for information on these devices.

This diagram shows the approximate placement of components for a QuietLink II cable installation (similar to those in the Whisper-Flex Installation Guide). Refer to the Whisper-Flex Installation Guide for exact instructions on installation procedures.

Draka EP can help you determine which size of Quiet Link II cable to use. Call your regional representative and have the following information ready:

- 1) number of hoist ropes per car
- 2) outer diameter of the hoist ropes
- 3) stranding of the hoist ropes (i.e. 8x19, 8x25...)
- 4) car roping (i.e. 1:1, 2:1, other...)
- 5) number of Quiet Link II cables per car
- 6) length of Quiet Link II cable needed

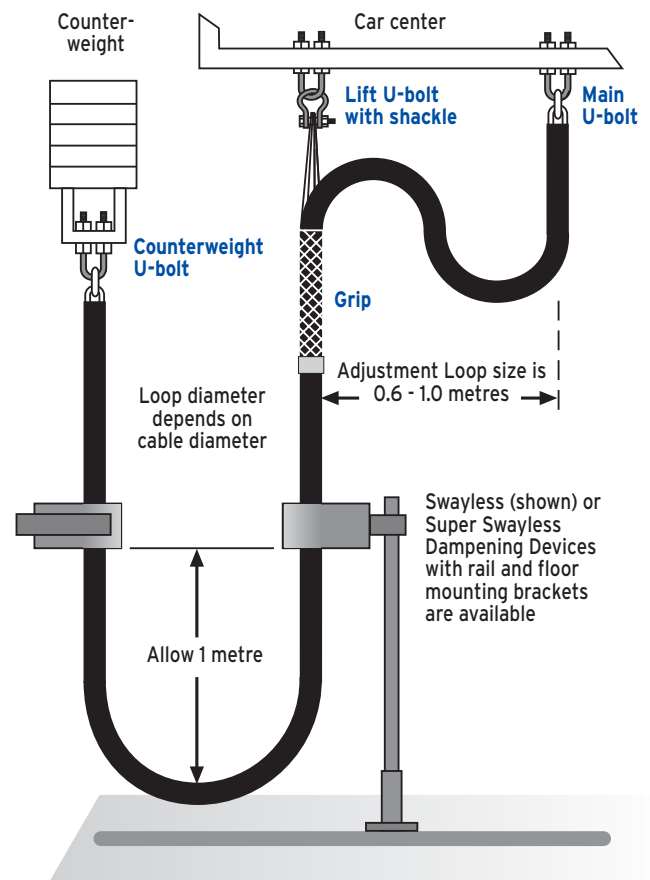

Wire Rope, Compensation & Accessories

QLII Installation Kits for QuietLink II cables (metric components)

Part Number	For Use on Cable	U-Bolt Part No.	Shackle Part No.	Grip Part No.	Max. Hang Length
IQL10	QL075 & QL10	U-M6	SH-M8	XG04-001	160 m
IQL15	QL125 & QL15	U-M8	SH-M10	XG04-002	130 m
IQL20	QL20	U-M10	SH-M10	XG04-002	160 m
IQL30	QL25 & 30	U-M12	SH-M12	XG04-003	180 m
IQL40	QL35 & 40	U-M14	SH-M14	XG04-004	150 m

THESE COMPONENTS ARE SPECIFICALLY DESIGNED FOR THE INSTALLATION OF METRIC COMPENSATING CABLES.

Metric Compensating Chain

Not available
in all areas

Easy-Balance™ chain

Part Number	Product Code	Cable Weight	Chain Trade Size (nom. ± 0.5 mm)	Cable Nom. OD	Maximum Hang Length	Nominal Loop Width
17-050-97	EB050	0.88 kg/m	6.0 mm	21 mm	180 m	280 mm
17-075-97	EB075	1.12 kg/m	7.0 mm	26 mm	180 m	280 mm
17-010-97	EB10	1.49 kg/m	8.0 mm	29 mm	180 m	300 mm
17-125-97	EB125	1.88 kg/m	9.0 mm	32 mm	180 m	300 mm
17-015-97	EB15	2.24 kg/m	10 mm	36 mm	180 m	300 mm
17-020-97	EB20	2.98 kg/m	11 mm	39 mm	180 m	300 mm
17-025-97	EB25	3.73 kg/m	13 mm	46 mm	180 m	300 mm
17-030-97	EB30	4.47 kg/m	14 mm	50 mm	180 m	320 mm
17-035-97	EB35	5.22 kg/m	15 mm	53 mm	180 m	320 mm
17-040-97	EB40	5.96 kg/m	16 mm	56 mm	180 m	320 mm



Easy-Balance chain provides quiet operation at temperatures of -15° C to +60° C, and can be used for elevators with rated speeds of up to 1.75 m/sec. Low carbon chain is coated with a flexible layer of PVC for quiet operation.

No shallow pit kits or special hardware (other than the recommended U-bolts - see page 73) are required with Easy-Balance compensation chain. Dampening devices are not needed.

Chain with intertwined rope

Part Number	Product Code	Chain Weight (nominal)	Chain Trade Size (nom. ± 0.5 mm)	Cable Nom. O. D.	Maximum Hang Length	Nominal Loop Width
17-S06-97	WFC/G-6	0.75 kg/m	6 mm	-	180 m	240 mm
17-S07-97	WFC/G-7	1.12 kg/m	7 mm	-	185 m	260 mm
17-S08-97	WFC/G-8	1.35 kg/m	8 mm	-	190 m	260 mm
17-S09-97	WFC/G-9	1.88 kg/m	9 mm	-	190 m	280 mm
17-S10-97	WFC/G-10	2.03 kg/m	10 mm	-	230 m	280 mm
17-S11-97	WFC/G-11	2.65 kg/m	11 mm	-	240 m	300 mm
17-S12-97	WFC/G-12	2.98 kg/m	12 mm	-	240 m	300 mm
17-S14-97	WFC/G-14	4.10 kg/m	14 mm	-	240 m	320 mm
17-S15-97	WFC/G-15	4.50 kg/m	15 mm	-	240 m	320 mm
17-S16-97	WFC/G-16	5.30 kg/m	16 mm	-	240 m	320 mm



Compensating chain with intertwined rope can be used for elevators with rated speeds of up to 1.75 m/sec. Sisal rope is intertwined with low carbon chain for quiet operation.

No shallow pit kits or special hardware (other than the recommended U-bolts - see page 73) are required with compensation sash chain. Dampening devices are not needed.

PVC-coated chain

Part Number	Product Code	Cable Weight	Chain trade Size (nom. ± 0.5 mm)	Cable Nom. O. D.	Maximum Hang Length	Nominal Loop Width
16-P06-97	WF-BS06	0.89 kg/m	6.0 mm	26 mm	180 m	220 mm
16-P07-97	WF-BS07	1.28 kg/m	7.0 mm	28 mm	185 m	240 mm
16-P08-97	WF-BS08	1.50 kg/m	8.0 mm	32 mm	190 m	260 mm
16-P09-97	WF-BS09	2.03 kg/m	9.0 mm	35 mm	190 m	280 mm
16-P10-97	WF-BS010	2.39 kg/m	10.0 mm	38 mm	230 m	280 mm
16-P12-97	WF-BS012	3.33 kg/m	12.0 mm	45 mm	240 m	300 mm
16-P14-97	WF-BS014	4.46 kg/m	14.0 mm	51 mm	240 m	320 mm



PVC-coated compensating chain provides compensation at temperatures of -30° C to +60° C, and can be used for elevators with rated speeds of up to 1.75 m/sec. Low carbon chain is coated with PVC for quiet operation.

No shallow pit kits or special hardware (other than the recommended U-bolts - see page 73) are required with compensation chain. Dampening devices are not needed.

Metric Compensating Cable/Chain Hardware

Designed specifically for metric compensating cable/chain as noted

Not available
in all areas

IEB installation kits for chain compensation

Part Number	For Use on Easy-Balance	For Use on Chain with Intertwined Rope	For Use on PVC-Coated Chain	U-Bolt Part No.
IEB050	EB050	WFC/G-6	WF-BS06	U-M6
IEB075	EB075	WFC/G-7	WF-BS07	U-M8
IEB125	EB10, EB125	WFC/G-8 & 9	WF-BS08 & 09	U-M10
IEB20	EB15, EB20	WFC/G-10, 11 & 12	WF-BS010 & WF-BS011	U-M12
IEB40	EB25, EB30, EB35, EB40	WFC/G-14, 15 & 16	WF-BS014	U-M14

IEB installation kits contain 2 U-bolts (includes nuts and washers).

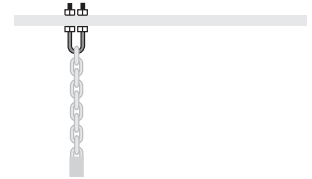

Steel U-bolt - with nuts, lock washers and cotter pins

Part Number	For use on Cables	Dim. A mm	Dim. B mm	Dim. C mm	Dim. T mm	Pin Diameter mm	Min.. Breaking Strength (kN)
U-M6	EB050	6.0	120	50	75	1.6	13.818
U-M8	EB075	8.0	120	50	75	2.0	22.246
U-M10	EB10, EB125	10	120	50	75	3.2	36.701
U-M12	EB15, EB20	12	120	50	75	4.0	57.183
U-M14	EB25, EB30, EB35, EB40	14	120	50	75	4.0	74.725

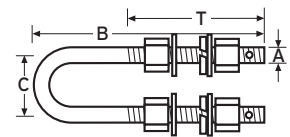

Steel shackle for QuietLink II - not available separately

Part Number	For use on Cables	Bolt Size mm	Pin mm	Dim. L1 mm	Dim. L2 mm	Dim. A mm	Dim. B mm	Min. Breaking Strength (kN)
SH-M8	QL075, QL10, QL125	M8 x 45	2.0 x 20	12.5	28.5	12	23	22.246
SH-M10	QL15, QL20	M10 x 50	2.5 x 20	12.5	28.5	12	23	36.701
SH-M12	QL25, QL30	M12 x 50	3.2 x 20	12.5	28.5	12	23	57.183
SH-M14	QL35, QL40	M14 x 60	3.2 x 20	18.0	36.0	16	27	74.725

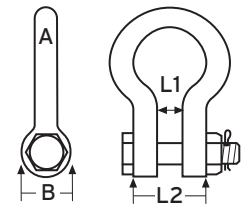

Stainless steel grips - double eye/double weave/closed mesh

Part Number	For use on Cables	Overall Length (nominal)	Breaking Strength (minimum)
XG04-001	QL075 & 10	710 mm	16 kN
XG04-002	QL15 & 20	710 mm	37 kN
XG04-003	QL25 & 30	710 mm	45 kN
XG04-004	QL35 & 40	710 mm	63 kN

THESE COMPONENTS ARE SPECIFICALLY DESIGNED FOR THE INSTALLATION OF METRIC COMPENSATING CABLES.



Wire Rope, Compensation & Accessories